

## Housing Document Instructions

- 1) Each building type is a separate excel sheet in this one document (reference the **tabs** at the bottom of the document)
- 2) Please reference the PDF file from the BCC Office to see the rooms that are part of your housing block. **The event housing block is emailed to the group leader prior to the event.**
- 3) Completed housing sheets with names are due to the BCC Office upon arrival. **Please be sure to only use the rooms in your housing block.**

**Bongiorno Conference Center  
SUITE HOUSING**

302	304	306
301	303	305

**FRONT (facing the park)**

<p><b>302</b> Sleeper Sofa _____</p> <hr/> <p>King _____</p>	<p><b>304</b> Sleeper Sofa _____</p> <hr/> <p>King _____</p>	<p><b>306</b> Sleeper Sofa _____</p> <hr/> <p>King _____</p>
<p><b>301</b> Sleeper Sofa _____</p> <hr/> <p>King _____</p>	<p><b>303</b> Sleeper Sofa _____</p> <hr/> <p>King _____</p>	<p><b>305</b> Sleeper Sofa _____</p> <hr/> <p>King _____</p>

**Suites 301-306** each have: **Living Room Side** with a queen pull-out sleeper sofa, kitchen, and full bath.  
**Bedroom Side** with a king-size bed and full bath.

<p><b>Cottage</b></p> <p>Bunk 1A _____</p> <p>Bunk 2A _____</p> <hr/> <p>King _____</p>
---

**Cottage Suite** has: **Seating Area** with a table and chairs, king-size bed, full bath, and kitchette.  
**Bedroom Side** with a bunk bed.

**Bongiorno Conference Center  
HOTEL HOUSING**

**FIRST FLOOR**

<b>102</b>	Queen	_____
<b>104*</b>	Twin 1 Twin 2	_____ _____
<b>106*</b>	Twin 1 Twin 2	_____ _____

**Foyer  
Fireplace  
Living Room Area**

<b>101</b>	Queen	_____
<b>103*</b>	Twin 1 Twin 2	_____ _____
<b>105*</b>	Twin 1 Twin 2	_____ _____
<b>107</b>	Queen Handicap Room	_____

<b>110*</b>	Twin 1 Twin 2	_____ _____
<b>112*</b>	Twin 1 Twin 2	_____ _____
<b>114</b>	Queen	_____

<b>109</b>	Queen Handicap Room	_____
<b>111*</b>	Twin 1 Twin 2	_____ _____
<b>113*</b>	Twin 1 Twin 2	_____ _____
<b>115</b>	Queen	_____

**SECOND FLOOR**

<b>202</b>	Queen	_____
<b>204</b>	Queen	_____
<b>208</b> Suite	King	_____
	Sleeper Sofa	_____
<b>210</b> Suite	King	_____
	Twin Sleeper Sofa	_____
<b>212*</b>	Queen	_____
<b>214*</b>	Queen	_____
<b>216</b>	Queen	_____

<b>201</b>	Queen	_____
<b>203*</b>	Queen	_____
<b>205*</b>	Queen	_____
<b>209</b> Suite	King	_____
	Sleeper Sofa	_____
<b>211*</b>	Queen	_____
<b>213*</b>	Queen	_____
<b>215</b>	Queen	_____

\* denotes adjoining rooms

**Bongiorno Conference Center  
HOTEL EAST HOUSING**

**FIRST FLOOR**

<p><b>121</b> Queen _____</p> <p>Bunk 1A _____</p> <p>Bunk 1B _____</p> <p>Bunk 2A _____</p> <p>Bunk 2B _____</p>	<p><b>122</b> Queen _____</p> <p>Bunk 1A _____</p> <p>Bunk 1B _____</p> <p>Bunk 2A _____</p> <p>Bunk 2B _____</p>	<p><b>123</b> Queen _____</p> <p>Bunk 1A _____</p> <p>Bunk 1B _____</p> <p>Bunk 2A _____</p> <p>Bunk 2B _____</p>	<p><b>124</b> Queen _____</p> <p>Bunk 1A _____</p> <p>Bunk 1B _____</p> <p>Bunk 2A _____</p> <p>Bunk 2B _____</p>
<p><b>125</b> Queen _____</p> <p><b>Handicap Room</b></p> <p>Bunk 1A _____</p> <p>Bunk 1B _____</p> <p>Bunk 2A _____</p> <p>Bunk 2B _____</p>	<p><b>126</b> Queen _____</p> <p>Bunk 1A _____</p> <p>Bunk 1B _____</p> <p>Bunk 2A _____</p> <p>Bunk 2B _____</p>	<p><b>127</b> Queen _____</p> <p>Bunk 1A _____</p> <p>Bunk 1B _____</p> <p>Bunk 2A _____</p> <p>Bunk 2B _____</p>	<p><b>128</b> Queen _____</p> <p>Bunk 1A _____</p> <p>Bunk 1B _____</p> <p>Bunk 2A _____</p> <p>Bunk 2B _____</p>

**SECOND FLOOR**

<p><b>221</b> Queen _____</p> <p>Bunk 1A _____</p> <p>Bunk 1B _____</p> <p>Bunk 2A _____</p> <p>Bunk 2B _____</p>	<p><b>222</b> Queen _____</p> <p>Bunk 1A _____</p> <p>Bunk 1B _____</p> <p>Bunk 2A _____</p> <p>Bunk 2B _____</p>	<p><b>223</b> Queen _____</p> <p>Bunk 1A _____</p> <p>Bunk 1B _____</p> <p>Bunk 2A _____</p> <p>Bunk 2B _____</p>	<p><b>224</b> Queen _____</p> <p>Bunk 1A _____</p> <p>Bunk 1B _____</p> <p>Bunk 2A _____</p> <p>Bunk 2B _____</p>
<p><b>225</b> Queen _____</p> <p><b>Handicap Room</b></p> <p>Bunk 1A _____</p> <p>Bunk 1B _____</p> <p>Bunk 2A _____</p> <p>Bunk 2B _____</p>	<p><b>226</b> Queen _____</p> <p>Bunk 1A _____</p> <p>Bunk 1B _____</p> <p>Bunk 2A _____</p> <p>Bunk 2B _____</p>	<p><b>227</b> Queen _____</p> <p>Bunk 1A _____</p> <p>Bunk 1B _____</p> <p>Bunk 2A _____</p> <p>Bunk 2B _____</p>	<p><b>228</b> Queen _____</p> <p>Bunk 1A _____</p> <p>Bunk 1B _____</p> <p>Bunk 2A _____</p> <p>Bunk 2B _____</p>

Each room has 1 queen bed, 2 bunk bed units, and full bath.

**Bongiorno Conference Center  
DAVID LEADERSHIP CENTER HOUSING**

**FRONT**

RM 508	RM 507	RM 506	RM 505
RM 501	RM 502	RM 503	RM 504

<p><b>508</b> Queen _____</p> <p>Bunk 1A _____</p> <p>Bunk 2B _____</p> <p>Bunk 1A _____</p> <p>Bunk 1B _____</p> <p>Bunk 3A _____</p> <p>Bunk 3B _____</p>	<p><b>507</b> Queen _____</p> <p>Bunk 1A _____</p> <p>Bunk 2B _____</p> <p>Bunk 1A _____</p> <p>Bunk 1B _____</p> <p>Bunk 3A _____</p> <p>Bunk 3B _____</p>	<p><b>506</b> Queen _____</p> <p>Bunk 1A _____</p> <p>Bunk 2B _____</p> <p>Bunk 1A _____</p> <p>Bunk 1B _____</p> <p>Bunk 3A _____</p> <p>Bunk 3B _____</p>	<p><b>505</b> Queen _____</p> <p>Bunk 1A _____</p> <p>Bunk 2B _____</p> <p>Bunk 1A _____</p> <p>Bunk 1B _____</p> <p>Bunk 3A _____</p> <p>Bunk 3B _____</p>
<p><b>501</b> Queen _____</p> <p>Bunk 1A _____</p> <p>Bunk 2B _____</p> <p>Bunk 1A _____</p> <p>Bunk 1B _____</p> <p>Bunk 3A _____</p> <p>Bunk 3B _____</p>	<p><b>502</b> Queen _____</p> <p>Bunk 1A _____</p> <p>Bunk 2B _____</p> <p>Bunk 1A _____</p> <p>Bunk 1B _____</p> <p>Bunk 3A _____</p> <p>Bunk 3B _____</p>	<p><b>503</b> Queen _____</p> <p>Bunk 1A _____</p> <p>Bunk 2B _____</p> <p>Bunk 1A _____</p> <p>Bunk 1B _____</p> <p>Bunk 3A _____</p> <p>Bunk 3B _____</p>	<p><b>504</b> Queen _____</p> <p>Bunk 1A _____</p> <p>Bunk 2B _____</p> <p>Bunk 1A _____</p> <p>Bunk 1B _____</p> <p>Bunk 3A _____</p> <p>Bunk 3B _____</p>

Each room has 1 queen bed and 3 bunk bed units with a full bathroom (showers, not tubs).

**Bongiorno Conference Center  
FOURPLEX HOUSING**

<b>601B</b>	<b>Lobby</b>	<b>601C</b>	<b>602B</b>	<b>Lobby</b>	<b>602C</b>	<b>603B</b>	<b>Lobby</b>	<b>603C</b>
<b>601A</b>		<b>601D</b>	<b>602A</b>		<b>602D</b>	<b>603A</b>		<b>603D</b>

**601A** Queen \_\_\_\_\_

Bunk 1A \_\_\_\_\_

Bunk 1B \_\_\_\_\_

Bunk 2A \_\_\_\_\_

Bunk 2B \_\_\_\_\_

Bunk 3A \_\_\_\_\_

Bunk 3B \_\_\_\_\_

**602A** Queen \_\_\_\_\_

Bunk 1A \_\_\_\_\_

Bunk 1B \_\_\_\_\_

Bunk 2A \_\_\_\_\_

Bunk 2B \_\_\_\_\_

Bunk 3A \_\_\_\_\_

Bunk 3B \_\_\_\_\_

**603A** Queen \_\_\_\_\_

Bunk 1A \_\_\_\_\_

Bunk 1B \_\_\_\_\_

Bunk 2A \_\_\_\_\_

Bunk 2B \_\_\_\_\_

Bunk 3A \_\_\_\_\_

Bunk 3B \_\_\_\_\_

**601B** Queen \_\_\_\_\_

Bunk 1A \_\_\_\_\_

Bunk 1B \_\_\_\_\_

Bunk 2A \_\_\_\_\_

Bunk 2B \_\_\_\_\_

Bunk 3A \_\_\_\_\_

Bunk 3B \_\_\_\_\_

**602B** Queen \_\_\_\_\_

Bunk 1A \_\_\_\_\_

Bunk 1B \_\_\_\_\_

Bunk 2A \_\_\_\_\_

Bunk 2B \_\_\_\_\_

Bunk 3A \_\_\_\_\_

Bunk 3B \_\_\_\_\_

**603B** Queen \_\_\_\_\_

Bunk 1A \_\_\_\_\_

Bunk 1B \_\_\_\_\_

Bunk 2A \_\_\_\_\_

Bunk 2B \_\_\_\_\_

Bunk 3A \_\_\_\_\_

Bunk 3B \_\_\_\_\_

**601C** Queen \_\_\_\_\_

Bunk 1A \_\_\_\_\_

Bunk 1B \_\_\_\_\_

Bunk 2A \_\_\_\_\_

Bunk 2B \_\_\_\_\_

Bunk 3A \_\_\_\_\_

Bunk 3B \_\_\_\_\_

**602C** Queen \_\_\_\_\_

Bunk 1A \_\_\_\_\_

Bunk 1B \_\_\_\_\_

Bunk 2A \_\_\_\_\_

Bunk 2B \_\_\_\_\_

Bunk 3A \_\_\_\_\_

Bunk 3B \_\_\_\_\_

**603C** Queen \_\_\_\_\_

Bunk 1A \_\_\_\_\_

Bunk 1B \_\_\_\_\_

Bunk 2A \_\_\_\_\_

Bunk 2B \_\_\_\_\_

Bunk 3A \_\_\_\_\_

Bunk 3B \_\_\_\_\_

**601D** Queen \_\_\_\_\_

Bunk 1A \_\_\_\_\_

Bunk 1B \_\_\_\_\_

Bunk 2A \_\_\_\_\_

Bunk 2B \_\_\_\_\_

Bunk 3A \_\_\_\_\_

Bunk 3B \_\_\_\_\_

**602D** Queen \_\_\_\_\_

Bunk 1A \_\_\_\_\_

Bunk 1B \_\_\_\_\_

Bunk 2A \_\_\_\_\_

Bunk 2B \_\_\_\_\_

Bunk 3A \_\_\_\_\_

Bunk 3B \_\_\_\_\_

**603D** Queen \_\_\_\_\_

Bunk 1A \_\_\_\_\_

Bunk 1B \_\_\_\_\_

Bunk 2A \_\_\_\_\_

Bunk 2B \_\_\_\_\_

Bunk 3A \_\_\_\_\_

Bunk 3B \_\_\_\_\_

Each room has 1 queen bed, 3 bunk bed units, and full bath.

**Bongiorno Conference Center  
EAGLE LODGE HOUSING**

<b>403</b>	Bunk 1A	_____
	Bunk 1B	_____
	Bunk 2A	_____
	Bunk 2B	_____
	Bunk 3A	_____
	Bunk 3B	_____
	Bunk 4A	_____
	Bunk 4B	_____
	Bunk 5A	_____
	Bunk 5B	_____
	Bunk 6A	_____
	Bunk 6B	_____

Minimum of 8 per room to qualify for Dorm Rate.

<b>404</b>	Bunk 1A	_____
	Bunk 1B	_____
	Bunk 2A	_____
	Bunk 2B	_____
	Bunk 3A	_____
	Bunk 3B	_____
	Bunk 4A	_____
	Bunk 4B	_____
	Bunk 5A	_____
	Bunk 5B	_____
	Bunk 6A	_____
	Bunk 6B	_____

Minimum of 8 per room to qualify for Dorm Rate.

<b>402</b>	Bunk 1A	_____
	Bunk 1B	_____
	Bunk 2A	_____
	Bunk 2B	_____
	Bunk 3A	_____
	Bunk 3B	_____
	Bunk 4A	_____
	Bunk 4B	_____

Minimum of 6 per room to qualify for Dorm Rate.

<b>405</b>	Bunk 1A	_____
	Bunk 1B	_____
	Bunk 2A	_____
	Bunk 2B	_____
	Bunk 3A	_____
	Bunk 3B	_____
	Bunk 4A	_____
	Bunk 4B	_____

Minimum of 6 per room to qualify for Dorm Rate.

<b>401</b>	Bunk 1A	_____
	Bunk 1B	_____
	Bunk 2A	_____
	Bunk 2B	_____
	Bunk 3A	_____
	Bunk 3B	_____
	Bunk 4A	_____
	Bunk 4B	_____

Minimum of 6 per room to qualify for Dorm Rate.

<b>406</b>	Bunk 1A	_____
	Bunk 1B	_____
	Bunk 2A	_____
	Bunk 2B	_____
	Bunk 3A	_____
	Bunk 3B	_____
	Bunk 4A	_____
	Bunk 4B	_____

Minimum of 6 per room to qualify for Dorm Rate.

<b>LOFT 17 Bunk Units (34 Beds)</b>	
Bunk 1A	_____
Bunk 1B	_____
Bunk 2A	_____
Bunk 2B	_____
Bunk 3A	_____
Bunk 3B	_____
Bunk 4A	_____
Bunk 4B	_____
Bunk 5A	_____
Bunk 5B	_____
Bunk 6A	_____
Bunk 6B	_____
Bunk 7A	_____
Bunk 7B	_____
Bunk 8A	_____
Bunk 8B	_____
Bunk 9A	_____
Bunk 9B	_____
Bunk 10A	_____
Bunk 10B	_____
Bunk 11A	_____
Bunk 11B	_____
Bunk 12A	_____
Bunk 12B	_____
Bunk 13A	_____
Bunk 13B	_____
Bunk 14A	_____
Bunk 14B	_____
Bunk 15A	_____
Bunk 15B	_____
Bunk 16A	_____
Bunk 16B	_____
Bunk 17A	_____
Bunk 17B	_____

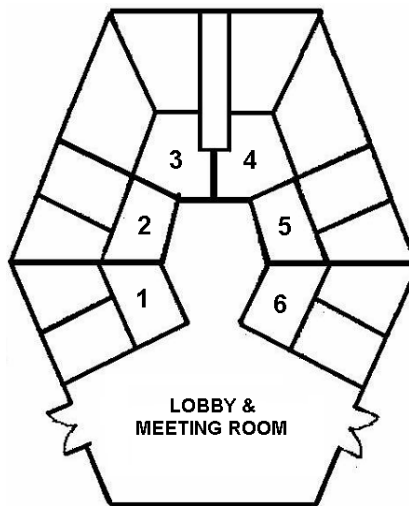

Guests provide sheets, blankets (or sleeping bag), pillows, towels, and soap.

**Bongiorno Conference Center  
WOODS DORM HOUSING**

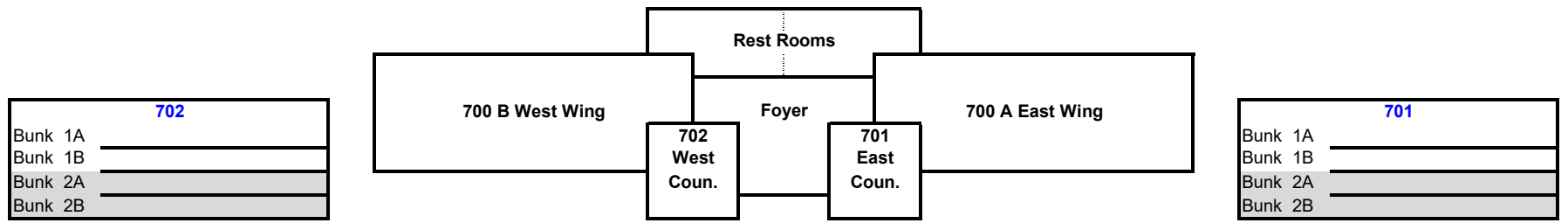

**700 B West Wing (Left Side)**  
Minimum of 20 (this side) to qualify for Dorm Rate

**700 A East Wing (Right Side)**  
Minimum of 20 (this side) to qualify for Dorm Rate

Bunk 1A _____ Bunk 1B _____ Bunk 2A _____ Bunk 2B _____  Bunk 3A _____ Bunk 3B _____  Bunk 4A _____ Bunk 4B _____  Bunk 5A _____ Bunk 5B _____  Bunk 6A _____ Bunk 6B _____  Bunk 7A _____ Bunk 7B _____	Bunk 8A _____ Bunk 8B _____  Bunk 9A _____ Bunk 9B _____  Bunk 10A _____ Bunk 10B _____  Bunk 11A _____ Bunk 11B _____  Bunk 12A _____ Bunk 12B _____  Bunk 13A _____ Bunk 13B _____  Bunk 14A _____ Bunk 14B _____	Bunk 1A _____ Bunk 1B _____  Bunk 2A _____ Bunk 2B _____  Bunk 3A _____ Bunk 3B _____  Bunk 4A _____ Bunk 4B _____  Bunk 5A _____ Bunk 5B _____  Bunk 6A _____ Bunk 6B _____  Bunk 7A _____ Bunk 7B _____	Bunk 8A _____ Bunk 8B _____  Bunk 9A _____ Bunk 9B _____  Bunk 10A _____ Bunk 10B _____  Bunk 11A _____ Bunk 11B _____  Bunk 12A _____ Bunk 12B _____  Bunk 13A _____ Bunk 13B _____  Bunk 14A _____ Bunk 14B _____
--	--	--	--

Each wing sleeps 28 guests and has access to a bathroom area.  
Guests provide sheets, blankets (or sleeping bag), pillows, towels, and soap.



**Bongiorno Conference Center  
CABIN HOUSING**

801	803
-----	-----

805	807
-----	-----

809	811
-----	-----

<p><b>801</b> Bunk 1A _____          Bunk 1B _____          Bunk 2A _____          Bunk 2B _____          Bunk 3A _____          Bunk 3B _____          Bunk 4A _____          Bunk 4B _____</p> <p style="color: red; font-size: small;">Minimum of 6 per room to qualify for Dorm Rate.</p>	<p><b>805</b> Bunk 1A _____          Bunk 1B _____          Bunk 2A _____          Bunk 2B _____          Bunk 3A _____          Bunk 3B _____          Bunk 4A _____          Bunk 4B _____</p> <p style="color: red; font-size: small;">Minimum of 6 per room to qualify for Dorm Rate.</p>	<p><b>809</b> <span style="float: right; color: red;"><b>Not Available</b></span>          _____          _____          _____          _____          _____          _____</p>
<p><b>803</b> Bunk 1A _____          Bunk 1B _____          Bunk 2A _____          Bunk 2B _____          Bunk 3A _____          Bunk 3B _____          Bunk 4A _____          Bunk 4B _____</p> <p style="color: red; font-size: small;">Minimum of 6 per room to qualify for Dorm Rate.</p>	<p><b>807</b> Bunk 1A _____          Bunk 1B _____          Bunk 2A _____          Bunk 2B _____          Bunk 3A _____          Bunk 3B _____          Bunk 4A _____          Bunk 4B _____</p> <p style="color: red; font-size: small;">Minimum of 6 per room to qualify for Dorm Rate.</p>	<p><b>811</b> <span style="float: right; color: red;"><b>Not Available</b></span>          _____          _____          _____          _____          _____          _____</p>

802	804
-----	-----

806	808
-----	-----

810	812
-----	-----

<p><b>802</b> Bunk 1A _____          Bunk 1B _____          Bunk 2A _____          Bunk 2B _____          Bunk 3A _____          Bunk 3B _____          Bunk 4A _____          Bunk 4B _____</p> <p style="color: red; font-size: small;">Minimum of 6 per room to qualify for Dorm Rate.</p>	<p><b>806</b> <span style="float: right; color: red;"><b>Not Available</b></span>          _____          _____          _____          _____          _____          _____</p>	<p><b>810</b> <span style="float: right; color: red;"><b>Not Available</b></span>          _____          _____          _____          _____          _____          _____</p>
<p><b>804</b> Bunk 1A _____          Bunk 1B _____          Bunk 2A _____          Bunk 2B _____          Bunk 3A _____          Bunk 3B _____          Bunk 4A _____          Bunk 4B _____</p> <p style="color: red; font-size: small;">Minimum of 6 per room to qualify for Dorm Rate.</p>	<p><b>808</b> <span style="float: right; color: red;"><b>Not Available</b></span>          _____          _____          _____          _____          _____          _____</p>	<p><b>812</b> <span style="float: right; color: red;"><b>Not Available</b></span>          _____          _____          _____          _____          _____          _____</p>

Each room has 4 bunk bed units, and full bath.  
 Guests provide sheets, blankets (or sleeping bag), pillows, towels, and soap.